

# Technical data sheet

Armoured steel pipe connection sleeve without thread, black

Item number: 2046586



Accessory part: plug-in sleeve for the connections between electrical installation pipes. With burr-free inner wall.



**St** Steel

**PE50** PES50 - Polyester/epoxy

## Master data

Item number	2046586
Description 1	Conduit plug-in coupler
Description 2	without thread
Manufacturer	OBO
Dimension	Ø40mm
Colour	Jet black; RAL 9005
Material	Steel
Surface	PES50 - Polyester/epoxy
Surface standard	
Smallest sales unit	25
Unit of quantity	Piece
Weight	13.2 kg
Weight unit	kg/100 pc.
CO Footprint (GWP) Cradle-to-Gate	0,2833 kg COe / 1 Piece

# Technical data sheet

Armoured steel pipe connection sleeve without thread, black

Item number: 2046586



## Dimensions

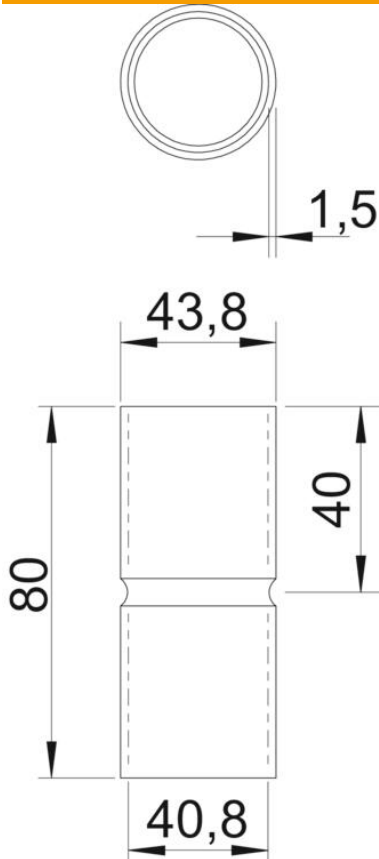

Length	80 mm
Dimension D	43.8 mm
Dimension d	40.8 mm
Dimension L	80 mm
Dimension I	40 mm
Dimension m (mm)	M40
Dimension t	1.5 mm

## Technical data

Version for pipe diameter	40 mm
Size	40
Halogen-free	yes
With inspection opening and lid	no
Brushed surface	no
Polished surface	no
Permitted temperature range, max.	400 °C
Permitted temperature range, min.	-45 °C
Two-part	no